

## CATTHORPE CONNECT

**W**ork to join up the A14 and M6 is proceeding apace with the recent opening of a direct link between the two roadways.

No longer does A14 traffic need to negotiate the historic bottle-neck and traffic hazard of the notorious 'dumb-bell' roundabouts, at a stroke, removing the congestion and traffic build-up that has caused so much frustration and grief in the past. All roads linking at the junction are now free-flowing without need to enter the minor road system at all.

Meanwhile, the temporary M6 - A14 east-bound link that has been running into the dumb-bells has now been stopped off and will eventually become the minor road link from Swinford to Catthorpe.

The A14-M6 links are presently running a 50mph contra-flow whilst the finishing touches are put to the carriageways, but traffic is nevertheless reported to be flowing freely. Locally this should mean that less traffic will be avoiding the junction and using the A5199 and A4304 as escape routes. Of course, the other benefit is that the accident rate caused by traffic backing up onto the major roads from the dumb-bells will be reduced. Good news for the safety of drivers and our local roads!

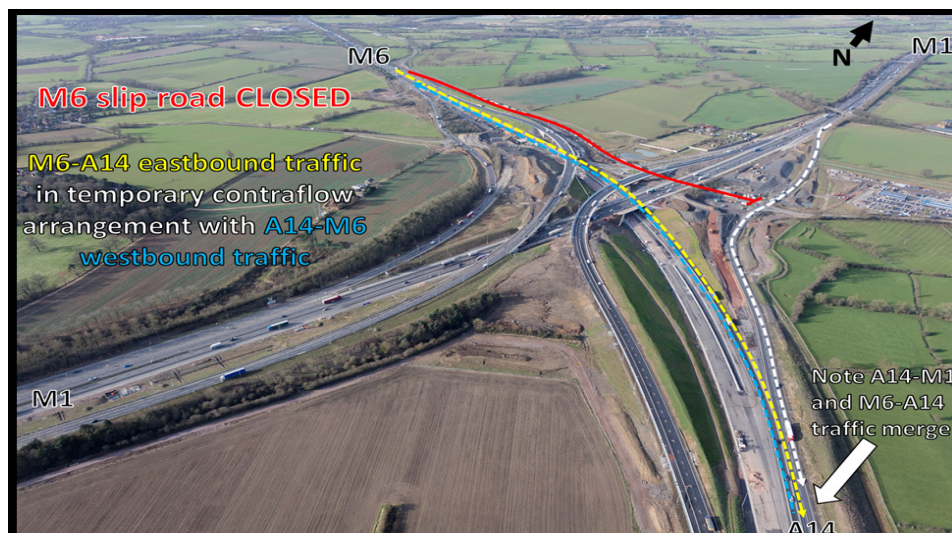

### PEBBLE HALL UPDATE

**A**t a recent meeting of the Pebble Hall Liaison group, members heard that work on the Renewable Energy Generating Facility (REGF) is scheduled to be completed this year and commissioned, following test runs, early in 2017. The plant will be fuelled by the woodchip waste that is at present being exported off the site. Currently a planning application is before Northamptonshire County Council seeking to extend the raw materials holding area to enable seasonal stock-piling of the waste.

Meanwhile, work on the Thermophilic Aerobic Digester (TAD) on the same site saw the main components of the facility installed late last year and testing is due to take place in April. The final commissioning of the plant and commencement of energy production is expected by the end of 2016 or early 2017.

Queries raised by the group included the operating hours, especially that of the woodchip transporters and the poor sheeting of outbound loads. The operators of the site agreed to look into the issues concerning operating hours and informed the meeting that a road-sweeper had been contracted to clear the roadside debris, including the soiled pavements through Bosworth village. It was noted that the woodchip waste wouldn't be exported from the site once the REGF was operating.

Following concerns raised about the odours and emissions from the plants once they were operational, representatives from the Environment Agency pointed out that there would be continuous monitoring of air quality to ensure that any discharges were within statutory limits. An overall manager for the site had been appointed and he assured the meeting that any problems will be dealt with quickly, including immediate closure of the site if necessary.

ISSUE 235

MARCH 2016

### THE BUGLE TEAM

#### Editor:

**Melvyn Forman**  
Firs Fm, Welford Rd. Tel: 880281  
Email: bosworth\_bugle@talk21.com

#### Treasurer:

**Ralph Horton**  
18 Highcroft Tel: 880526

#### Advertising:

**Sylvia Price**  
3 Highcroft Tel: 880902  
Email: sylvia1\_p@hotmail.co.uk

#### Contacts:

**Mike Price**  
3 Highcroft Tel: 880902

**Jo Horton**  
18 Highcroft. Tel: 880526

**Frances Smith**  
10 Butt Lane Tel: 880225

**Penny Mattock**  
9 Fernie Court Tel: 881140

**Heather O'Connor**  
16 Fernie Court Tel: 880165

#### Postal Subscription/distribution:

**Lorrie Forman** Tel: 880281  
Email: l.forman@talk21.com

[www.husbandsbosworth.info](http://www.husbandsbosworth.info)

#### COPY DEADLINE

15<sup>th</sup> OF THE MONTH

PRECEDING PUBLICATION

### VILLAGE CLEAN-UP

**P**lease note that the Village Clean-Up will now be on **Saturday, March 5<sup>th</sup>, 2.00pm to 4.00pm**. Meet outside the Village Hall.

This is a national initiative led by the *Council to Protect Rural England (CPRE)* and *Tidy Britain Campaign* to tidy up the whole of the country in readiness for the 90<sup>th</sup> birthday of HM The Queen in April.

We were a bit surprised that this weekend was chosen, as soon after we publicised it as March 6<sup>th</sup> in the February *Bugle* we noticed that it was Mothering Sunday.

Presumably the thinkers and policy-makers within *CPRE* and *Tidy Britain* don't have mothers!

### SUMMERTIME

**R**EMEMBER British Summer Time commences and clocks go forward on Sunday, March 27<sup>th</sup>, yippee...



## POSTBAG

*From Penny Mattock, Fernie Court*

I would like to give heartfelt thanks to everyone who sent messages, letters and cards of condolence for Ken and also to those who attended his funeral. The support was overwhelming and it was comforting to know how many people knew and liked him. I would also like to take this opportunity to thank all the staff at Husbands Bosworth Surgery for their wonderful care, concern and support to Ken and myself during his illness. It was a great comfort and much appreciated.

*From Ralph & Jo Horton, Highcroft*

A big thank you to everyone who attended the recent 'Govannen' concert at the Village Hall. We were superbly entertained by the band and we hope that you all enjoyed yourselves. The concert raised over £700 for the Village Hall with an additional £600 being raised for Sue Dhillon's Belarus Orphan's Charity, in an auction very ably and amusingly conducted by Bill Fletcher.

### POLICE FILE

**IF YOU HAVE INFORMATION ON ANY CRIMINAL ACTIVITY CALL MARKET HARBOROUGH POLICE on 101**  
**Neighbourhood Watch Co-ordinator**  
**Stephen Bilbie**  
stephenbilbie@btinternet.com  
NW Community Scheme No. 2123

### Lutterworth South Neighbourhood Team

**Sgt. 2241 Mark Williams**  
**PC 1291 David Sharpe**  
**PCSO 6569 Peter Willson**  
**PCSO 6008 Laura Bolton**  
**PC 4203 Niké Diaper**  
Voicemail Service 0116 2485675  
**CRIMESTOPPERS**  
**FREEPHONE 0800 555111**

## WATCH WORD

*THE NEIGHBOURHOOD WATCH SCHEME WITHIN HUSBANDS BOSWORTH*

- Criminal damage to property, Naseby Road, Sibbertoft
- Spate of attempted theft of vehicles, Church Lane, Welford
- Damage to property, Church Lane, Welford
- Theft of items from vehicle parked off Naseby Road, Welford
- Burglary to premises, Mere Lane, Upper Bruntingthorpe
- Theft from isolated property, Welford Road, Knaptoft
- Theft of vehicle, Main Street, Laughton
- Theft of vehicle, Bakehouse Lane, Saddington

### SID REPORT

Readings from the Speed Indicator Device

#### **Theddngworth Road westerly**

Period: 20.01.16 - 27.01.16  
Vehicle movements: 12012  
Average movements per day: 1716  
Average speed: 30.96mph  
*Highest recorded speed: 55mph*

#### **Theddingworth Road westerly**

Period: 27.01.16 - 03.02.16  
Vehicle movements: 11682  
Average movements per day: 1669  
Average speed: 31.05mph  
*Highest recorded speed: 54mph*

#### **High Street easterly**

Period: 03.02.16 - 10.02.16  
Vehicle movements: 15642  
Average movements per day: 2235  
Average speed: 26.94mph  
*Highest recorded speed: 64mph*

#### **High Street easterly**

Period: 10.02.16 - 17.02.16  
Vehicle movements: 16170  
Average movements per day: 2960  
Average speed: 27.02mph  
*Highest recorded speed: 64mph*

As the mornings are still very frosty, please remember not to leave your vehicle unattended with the engine running. Opportunists never take a day off and we still have reports of unattended vehicles being stolen.

In view of recent wet weather and high winds the Police are advising drivers to prepare themselves for driving safely in poor weather conditions. Check for weather alerts that might affect your journey, only travel if absolutely necessary and plan your route avoiding any roads that are prone to flooding.

Check lights and always drive with dipped head lights and ensure that window wipers are in good condition and that tyres have the correct pressure and good tread for maximum road grip. Reduce your speed when travelling in rain to decrease your stopping distance. Keep your mobile phone battery topped up and the number of your rescue recovery service stored, in the event of a breakdown.

Lutterworth Police Beat Surgery will be held in Lutterworth Library on Friday, April 1<sup>st</sup> 2.30pm - 4.30pm. Please come along and see us there.

**The Lutterworth Beat Team**



**T: 01858 575 555 W: [www.theatticrestaurant.co.uk](http://www.theatticrestaurant.co.uk)**

**South Kilworth Road, North Kilworth, LE17 6HJ**



**P.C. BUILDING SERVICES LTD**

Established  
27 years



Complete building service  
Specialist in new build  
Quality renovations  
& Extensions

**Tel/Fax 01858 881202**

**Email: [pcbuidserv@btinternet.com](mailto:pcbuidserv@btinternet.com)**

Walton Grange, Bosworth Road  
Walton, Lutterworth, Leics LE17 5RW



# BOSWORTH IN FOCUS

A ROUND-UP OF LOCAL NEWS

## BRIAN OF BOSWORTH...

The annual Battle of Bosworth Village Hall fund-raising quiz, which took place on Saturday, February 20<sup>th</sup>, saw 13 teams competing over ten testing rounds of questions.

The contest, which was hosted by last year's winners, *The Village Idiots*, Wendy, Ceri, Tom and Penny, was convincingly won by *The Strife of Brian* team, of Eleanor, Brian, Arwyn and Steph, who take up the dubious honour of setting and hosting the quiz next year!

We would like to draw attention to the gallantly fought second place, where the *Bugle 1* team of Mike, Sylvia, Ralph and Jo, live on, to fight another day!

The *Third Time Lucky* team unfortunately failed in their third attempt to take the Village Hall quiz glory, but were awarded a special prize for propping up the foot of the scoreboard.

A total of £130 was raised for the Village Hall funds.

*For newcomers to the village, the Village Hall Quiz is something of a Husbands Bosworth institution, and has been held every year since 1981.*

## WILD ABOUT BOSWORTH

### A Good Hare Day

Brown or European Hare (*Lepus europaeus*)

Around the time of the spring equinox, take an early morning walk in the countryside and you are almost guaranteed to see hares cavorting in the fields. With luck, you will spy a 'drove', (the collective noun for hares), playing 'hare chess'.

The rules are a little mysterious, but they appear to involve making random positional moves about the field. Then, at a signal imperceptible to human senses, the contest enters its chase and fight phase! After a wild pursuit, the combatants rear up on their hind legs and rain blows down on each other's head and shoulders.

The pace of these conflicts is so rapid it is difficult to follow the action. Hares can reach a top speed of around 45mph; that's slightly faster than a fox. Anatomically, their hearts account for over one percent of their body weight. It's this adaptation which pumps the blood needed to power their madcap antics.

Another endearing trait is their inquisitiveness. If they see something strange in their territory, provided it's stationary, they are more likely to investigate than run away. Once, while out walking, I noticed a leveret heading in my direction. As I did my best statue impression, the creature hopped ever closer, fifty yards, thirty, ten and finally five yards, all the while eyeing me with open curiosity.

Because of their fertility, hares make frequent appearances in mythology. They're chiefly associated with good fortune, sexuality and procreation. Folk magic says that eating hare meat for seven days will make you beautiful but, after experimentation, I've discovered this isn't true... And beware of hares running *widdershins* round you (anticlockwise), as these bring bad luck.

*Mike Chanter*



## WEATHER LOG

January 2016 [2015]

Rain: 84.5mm (3.3") [45.25mm]

Wettest day: 12mm (0.5") [9mm]

Highest temp: 12°C [13°C]

Lowest Temp: -3°C [-5.5°C]

Snow: 2½" [3½"]



## BOSWORTH FESTIVAL 2016

Bosworth Festival Committee have confirmed the date of Bosworth Festival 2016 as Saturday, June 25<sup>th</sup>. See you there!

### VILLAGE HALL BOOKINGS

Mick Bromley 07442 954729

husbandsbosworthvh@gmail.com

www.husbandsbosworthvillagehall.co.uk

### CHURCH HALL BOOKINGS

Janice Staples 880668

Bob Hutchings 880131

### SPORTS PAVILION ENQUIRIES

Audrey Marlow 880316

## COFFEE MORNING

### ADVANCE NOTICE

There will be a Coffee Morning and Bring and Buy Sale in aid of LOROS on Saturday, April 9<sup>th</sup>, 10.00am to 12.00noon in the Church Hall, Honeypot Lane.

## LOROS CHANGE

An incredible £398.03 has been raised for LOROS in just over the year from the collecting tin in Springfields Supermarket in Husbands Bosworth.

Thank you to everyone who has put their change into the tin and thank you to Roy Holyland for allowing the Loros collecting box to be in the Supermarket.

## 'JJ's Kiddycare'



- \*OUTSTANDING\* Ofsted grading
- \* FREE Pre-school sessions for 2, 3 & 4 year olds
- \* Full Day Care 0-5yrs
- Situated on a farm site between South Kilworth and Welford
- \* Breakfast and After School clubs. (4-14years)
- \* Holiday Clubs during all Northants & Leics school breaks

Tel no. 01858 575642  
www.jjs-kiddycare.co.uk



## COMPLETE CAR CARE

Accident repair specialist

Bodywork, dent, scratch and stone-chip repair

Servicing, alloy refurbishment, welding

MoT repair

Valeting, full body polish

Parking sensors, tyres & exhausts, etc. fitted

Call Ben on 01858 880404

bencompletecarcare@outlook.com

# SCHOOL REPORT

HUSBANDS BOSWORTH C. of E. PRIMARY SCHOOL Head Teacher Louisa Morris

School closes March 23<sup>rd</sup>; re-opens April 11<sup>th</sup>

## FOBS NEWS

### ADVANCE NOTICE

The FOBS team have an exciting list of events coming up this year:

- There will be a Walking Treasure Hunt on the May 15<sup>th</sup>. Look out for further details.
- The FOBS Safari Supper, which as proved very popular over the years, will be held this year on June 18<sup>th</sup>.
- FOBS will be at the Bosworth Festival on the June 25<sup>th</sup>, 'manning' the tea tent!
- There will be a special Christmas event, with dinner and entertainment, on November 26<sup>th</sup>.

## BYGONE BOSWORTH

Images from the Historical Society's Archive Collection

As a bit of a follow-up from the article last month about the dear old Fernie we have unearthed this picture of part of the frontage.

A feature of the approach to the hotel entrance was the collection of horse-drawn carriages that were strategically parked as eye-catchers amongst the flower beds. Former villager, Hilda Carter tells us that it was her late husband, Norman's job to maintain the grounds and flower beds, whilst Hilda worked in the hotel itself, when the proprietors were Mr. and Mrs. Speight.

The BBC *Domesday Reloaded* survey of Husbands Bosworth undertaken by the village school children, and published in 1986 makes interesting reading. At the time of the survey the Fernie was owned by Mr. and Mrs. Hayes, who took over from the Speights. The children noted *...most of their customers come from Leicester, Coventry and Northampton. They get a lot of customers from big cities like London. They serve 200 people a day during a week. But at the weekends they serve about 300 people per day. They serve English food at the restaurant, and a 4-course meal costs £11.50. They employ 70 people. There are 21 rooms altogether.*

*Previously it was used for a residential home for elderly women and a private club for American service men then a hotel and a public house. The building is 185 years old.*

Dave Alley, of Kilworth Road reminds us that as Hillsome House during the war, the Fernie was requisitioned for use as a school and accommodated a complete school evacuated from London's East End. Dave also recalls that those having school dinners at the village school were walked down to the Fernie for the meal.



## TRADE DIRECTORY 2016

**Armourededdon Tank Paintballing Centre**  
Military vehicles, paintball & outdoor activities  
Contact: Tracey 01858 880239

**Croft Farm Bed & Breakfast**  
AA 4\*\*\*\* accommodation  
Contact: Jane Smith 880679

**Mike Price Heating Engineer**  
Oil-fired boiler servicing & repair  
Contact: Mike Price 880902

**Totally Trees Ltd.**  
Tree surgery and stump grinding  
Contact: Jacqui Mitchell 01455 554182

**Woodpecker Tree Surgery**  
All aspects of tree surgery undertaken  
Contact: Chris Wright 880818

To advertise here call Sylvia  
on 880902  
or Email: [sylvia1\\_p@hotmail.co.uk](mailto:sylvia1_p@hotmail.co.uk)

## SCAM ALERT

**Fraudsters are sending out virus-infected emails claiming a package has been seized by HM Revenue & Customs upon arrival into the United Kingdom. The official looking emails claim to be from Royal Mail and contain a links which will install malicious software on your computer. An example email reads:**

*"Royal Mail is sorry to inform you that a package addressed to you was seized by HM Revenue & Customs. We think that you may have been a victim of counterfeit merchandise and this item has been confiscated. Royal Mail Group UK will notify you on how to get your money back.*

*Please review the attached document for more information. Please accept our apologies for any inconvenience this may have caused."*

**\*\*Don't open any attachments relating to this email\*\***

If you believe that you have been a victim of fraud you can report it online: [www.actionfraud.police.uk/report\\_fraud](http://www.actionfraud.police.uk/report_fraud) or by telephone: 0300 123 2040



- **Open to the Public**
- **Golf Course, Driving Range, Tuition**
- **Bar & Restaurant - Open All Day**
- **Event & Conference Facilities**



T: 01858 575 082 E: [admin@kilworthsprings.co.uk](mailto:admin@kilworthsprings.co.uk)

W: [www.kilworthsprings.co.uk](http://www.kilworthsprings.co.uk)



**TO ADVERTISE HERE COSTS  
JUST £12 PER MONTH**  
THE *BUGLE* IS DELIVERED FREE TO EVERY  
HOUSEHOLD IN THE PARISH AND REACHES  
PLACES OTHER PUBLICATIONS CAN'T REACH!

Call Sylvia on 880902  
or Email: [sylvia1\\_p@hotmail.co.uk](mailto:sylvia1_p@hotmail.co.uk)



## ACTIVITY GROUPS 2016

### All Saints Parochial Church Council

Contact: Diana Jones 880741

### Baby-Sitting Circle

Contact: Claire Scott 880295

### Badminton Club

Contact: Ralph Horton 880526

### Beaver Scout Troop

Contact: Stuart Dainton 881431

### Bosworth Tots

Contact: bosworthtots@hotmail.co.uk

### Brownie Guides

Contact: Bonny Kettell 882148

### Conservative Association

Contact: Robert Maxwell 880361

### Craft Group

Contact: Gail Wilmot 880413

### Historical Society

Contact: Melvyn Forman 880281

### Husbands Bosworth Rainbows Group

Contact: Wendy Cochrane 880076

### 1st Kilworth Scouts/Beaver unit

Contact: Stuart Dainton 881431

### Lutterworth African Drumming Group

Contact: Ralph Horton 880526

### Millennium Woodland Trust

Contact: Jackie Fletcher 880910

### Playing Field Committee

Contact: Jennifer Rogers 880401

### Royal British Legion

Contact: Robert Maxwell 880361

### Tennis Club

Contact: Jennifer Rogers 880401

### Tower Bell Ringers

Contact: Geoff Armitage 880066

### Workers Education Association

Contact: Sally Sherratt 571064

## ACTIVITY GROUPS

### HISTORICAL SOCIETY

The next meeting of the Historical Society will be on Wednesday, March 2<sup>nd</sup> when David Price will be telling us about the *Hollywood Production Code*.

In the 1930s the US film industry adopted a code of self-censorship to counter growing criticisms of 'offending against common decency'.

The Puritanical zeal extended to bedroom scenes where the actors were obliged to have one foot on the floor at all times!

David will look at the industry before and after the Code and the high profile artistes who were embroiled in the shake-up - with film clips and images!

The meeting is in the Church Hall, Honey Pot Lane and starts at 7.30pm. Visitors welcome. For more information please call Melvyn on 880281.

### CRAFT GROUP

The group meets on the second Wednesday of each month in the Committee Room of the Village Hall.

If you have a craft or pastime that is reasonably portable and would welcome the opportunity to share tips with other like-minded crafty folk why not come along? Meetings are friendly and informal and refreshments are available. There is a small charge to cover costs.

Call Gail on 880413 for details.

### MILLENNIUM WOOD

The next Millennium Wood workparty will be on Saturday, March 19<sup>th</sup>, 9.30am to 12.00noon, meeting at the Wood.

Anyone wishing to have an enjoyable work-out in the fresh air, whilst helping the group get the community woodland ready for spring will be assured a warm welcome (and coffee and biscuits...).

Stout footwear and old clothes are recommended!

Call Jackie on 880910 or Lorrie on 880281 for further information.

### VILLAGE LUNCHEON

The next Village Luncheon will be on Tuesday, March 29<sup>th</sup> at Kilworth Springs Golf Club.

Diners are asked to meet as usual in the Club-house at 12.30pm.

To book a place or for further information please call Janice on 880668.

### WHIST

Since Brenda Brown retired from running the Whist Drive at Kilworth Springs on the first Monday of the month, members from All Saints Church have taken on the challenge. In the last few months this Whist Drive and many others in the district have dropped in numbers, some even closing.

We are trying not to let this happen. At the moment there are sufficient players to make it viable but there is room for more people and one of the members has kindly offered to give lessons. Why not take up the challenge. Where can you go for an afternoon out for £3, with prizes, free raffle and tea/coffee and biscuits?

Members of the Whist Drive are keen to encourage people to get involved with All Saints. Offers of help and ideas for fund raising are always very much appreciated. Please call Di on 880741.

*Di Jones*

### BOSWORTH TOTS

Bosworth Tots is a stay-and-play session for tots (from birth to pre-school) and their parents, grandparents, carers and child minders.

The group meets from 9.30am to 11.30am (term time only) on Thursday mornings at Husbands Bosworth Village Hall.

The cost is £2.50 for one child and then 50p for each additional child thereafter.

For more details email: bosworthtots@hotmail.co.uk

*STOP PRESS: The group has recently been awarded a grant from the Parish Council to provide new play equipment.*

### CAUSEWAY COFFEE

A Coffee Morning, hosted by the Causeway Charity group, is held on the second Friday of each month in the Church Hall, Honey Pot Lane. Older villagers, especially those retired, housebound or living alone, along with their carers, are invited to come along, share a chat and catch up on all the local gossip over a relaxing cuppa, biscuit or a slice of homemade cake.

The next meeting is on Friday, March 11<sup>th</sup>, 10.00am to 11.30am and this month there will be another opportunity to try indoor curling! (*It's like ice curling but is played in the Church Hall, and not on ice, so it's warmer and can be played sitting down!*)

# Karting

Leicester Airport, Gairtree Rd, Gt Stretton, Leicester. [www.stretton2000.com](http://www.stretton2000.com)

## The UK's Premier Karting experience

850M floodlit racing circuit
Licensed Bar & Function room
Slag & Hen Parties

Corporate & Team Building Activities
Childrens Parties

60 Mph, 300cc Thunder Karts
Kart Club & Championship Races

Junior Kart's Available
Gift Vouchers Available

Arrive & Drive Sessions

## Stretton Circuit 0116 259 2900

Open 7 days a week 10.00am - 9.00pm

WEDDINGS • PARTIES • CORPORATE



## Lodge Farm

### LUXURY TOILET HIRE

01858 882176

[www.lodgefarmluxurytoilethire.co.uk](http://www.lodgefarmluxurytoilethire.co.uk)

A Luxury Loo for your Posh Do!

# PARISH COUNCIL NEWS

Report of the Parish Council meeting held on Tuesday, February 2<sup>nd</sup> 2016

*In attendance, full Council, District Councillor Lesley Bowles, Canal & River Trust local co-ordinator, Sarah Brown and two members of the public.*

## Visitors' Questions

■ A resident brought to Council's attention problems of discarded dog poo bags blocking drains in Green Lane. Clerk was asked to contact Highways to ensure that the drain was cleared.

■ Also brought to the attention of Council was the increase in incidents of wide vehicles using Green Lane and causing damage to the adjacent properties. The problem seemed to be linked to delivery vans and the sat-nav systems used. Clerk was asked to notify Highways of the problem, with a view to installing carriageway width notices.

■ Another resident enquired why, since the footway on Welford Road had been cleared, similar work hadn't been carried out on Kilworth Road and Leicester Road, which were equally as bad and used more.

■ Sarah Brown, of Canals & River Trust addressed the meeting to discuss proposals put forward by Council to move towards 'adopting' a section of the canal towpath through the village. Ms Brown advised Council that CRT would support local volunteering and recruitment, promotional events, grant application and fundraising. Once schemes were underway, training of volunteers would be undertaken, design and specification and work supervision would be provided. Appropriate safety training and specialist equipment would be provided where necessary.

■ Local issues were raised and it was agreed that the section of towpath between Honeypot Bridge and the tunnel eastern portal would be considered as a priority scheme. Ms. Brown also agreed to discuss public safety issues, relating to the historic horse blind fencing on the boathouse path alongside the disused railway, with CRT heritage officers. Chairman thanked Ms Brown and the members of the public for attending. *At this point the visitors left the meeting.*

## Minutes of the Previous Meeting were read. Matters Arising from the Minutes

■ Clerk informed Council that the hedge along School Lane had been trimmed back.

■ Problems with the play equipment, highlighted at the RoSPA report, had been referred to the installer who assured Council that the equipment was compliant with current legislation.

■ Repairs to vandalised guttering and cladding had been undertaken on the Pavilion to a cost of £187.43. Work to replace slabs would be undertaken when weather conditions were more favourable.

## Cemetery

■ Council noted that the margins had been trimmed back.

■ Presence of a mole was found. Clerk to contact pest control contractor.

■ Members discussed proposals to seal the south doorway of the Chapel of Rest with a breeze-block infill as a matter of urgency. A false door could be installed on the outside later to restore the building's external appearance. Clerk was asked to obtain quotations for this work.

## Allotments

■ It was noted that a rent review should be undertaken in time for the new letting year

## Broadband

■ Members were concerned that connection provision was proving problematic with some service suppliers. Mrs. Hobson had discussed this with representatives at County Hall who had assured her that they were working alongside BT to solve service supply problems.

## Correspondence

■ Council had received correspondence relating to Bosworth Tots pre-school group seeking funding to provide additional equipment and to promote the group's activities. Council agreed a grant from the Community Fund.

## Any Other Business

■ Clerk was asked to bring to the attention of Highways the state of the grass verge outside Hunters Lodge on Berridges Lane, the footway on Leicester Road opposite the entrance to Safewater Farm and the blocked storm drains on Welford Road.

■ Chairman informed the meeting that at the next meeting of the Pebble Hall Liaison Group he would bring to the attention of the operators the parlous state of the footways and drains on High Street.

■ Council also discussed the parking problems in the lay-by outside the cemetery on Welford Road. It was noted that HGVs were parking there at break times and leaving debris and mud. Clerk was asked to enquire with Highways if a parking restriction could be applied.

*The next meeting of the Parish Council will be on Tuesday, March 1<sup>st</sup> 2016 at 7.45pm in the Committee Room of the Village Hall.*

## LOCAL OFFICERS

### Husbands Bosworth Parish Council:

#### Councillors

William Fletcher	880910 (Chairman)
Melvyn Forman	880281
Susan Fisher	880026
Patricia Hobson	880070
James Shelley	880170

#### Parish Clerk

Jackie Fletcher,  
13 School Lane,  
H.B. LE17 6JU

Tel: 880910

E-mail: jackiehbpc@btinternet.com

#### District Councillor

Lesley Bowles

Email: l.bowles@harborough.gov.uk

#### County Councillor

Graham Hart

Lilac Cottage

Willoughby Waterleys

Leicester LE8 6UF

Tel: 01162 478600

E-mail: graham.hart@leics.gov.uk

**ROB DARGUE**  
**CARPENTRY & BUILDING Ltd.**  
**Husbands Bosworth**



**ALL ASPECTS OF CARPENTRY & BUILDING WORK**  
**EXTENSIONS & ALTERATIONS**  
**KITCHENS, BATHROOMS & TILING**

**Friendly, reliable service**

**For a free quotation call Rob**  
**01858 880803 or 07834 872205**  
**www.robarguecarpentry.co.uk**



## WOODPECKER

### TREE SURGERY

**All aspects of tree-work undertaken from dismantling large roadside trees to pruning and reshaping small garden trees.**

**We also offer a stump grinding service.**

**Professionally qualified and insured.**

**For free quotation and advice call**

**Chris on: 01858 880818**

**www.woodpeckertrees.com**

# CHURCH NEWS

*All Saints Parish Church, Methodist Chapel & St. Mary's Roman Catholic Church*

## From the Rectory

Do you sometimes feel taken for granted? Or, take others for granted? In a busy life it is inevitable that this will be the case. We rely on other people to do what they always do in order for us to keep on with the things we have to do. If this is always the case then eventually people feel used and unappreciated. It takes times of leisure together, times of putting the other person first, sometimes a simple 'Thank you, I really appreciate what you do for me', to put the matter right.

It is the same with God. Most of the time we take Him for granted. We rely on Him to sustain the world so we can enjoy living in it, we depend on Him to protect us from danger, and pour out his blessings on us.

Maybe we also take for granted that Jesus's death on the cross and his resurrection will get us into Heaven because we live in a Christian country and somewhere in the back of our mind that is what we believe. But, how much more reassuring it will be for us if we pay attention to our relationship with God more, if we appreciate what he does for us and the things he gives us in our world today.

In our human relationships, spending a bit of time with God, saying thank you, talking with him or just being quiet with him will make all the difference to the quality of our relationship. God doesn't take us for granted. The Bible tells us that God says: '*...you are precious in my sight, and honoured, and I love you.*'. He continues to provide and protect and to love, and he waits for us to spend a little quality time with him.

Maybe this Easter season is a good time to give him some attention.

Every blessing for a happy, holy and peaceful Easter (and much chocolate to you all). *Liz*

## CELEBRATION OF MARRIAGE

All Saints Church is hosting a Celebration of Marriage on Saturday, April 23<sup>rd</sup> and Sunday 24<sup>th</sup>, 10.30am to 5.00pm, to celebrate the Queen's 90<sup>th</sup> birthday. We hope to have dresses and memorabilia on display which show the changes in the last 90 years. We will also have some quilts on display. There will be refreshments, and the weekend will conclude with a Service of Thanksgiving for families and married life.

If you have a wedding dress, bridesmaid dress, going-away outfit or quilt that we could borrow, or mannequins for display purposes, please call Di on 880741 or Lorrie on 880281.

## Parish Notices

**James Cunningham**

*of Hillcrest Lane*

Died January 30<sup>th</sup> 2016

Age 79 years

**Herbert Embley**

*formerly of Kilworth Road*

Died January 31<sup>st</sup> 2016

Age 86 years

**Kenneth Mattock**

*of Fernie Court*

Died January 31<sup>st</sup> 2016

Age 84 years

**R.I.P**

## ALL SAINTS FLOWER ROTA MARCH:

*Lent (No flowers)*

Call Heather O'Connor on 880165

if you would like to join the Flower Rota

## METHODIST CHURCH

### Coffee Morning

Wednesday, March 16<sup>th</sup> 10.00am-12.00noon.

at the home of John & Margaret Scurrah  
25 High Street

Visitors always welcome.

## †CHURCH SERVICES †

### Hexagon Benefice

6 9.30am Communion Shearsby with Mowsley  
9.30am Morning Prayer HB  
11.00am Communion Thed.  
11.00am Family Service B'thorpe  
6.00pm Communion Arnesby

13 9.30am Morning Prayer Shearsby  
9.30am Family Service Arnesby  
11.00am Communion HB  
4.00pm Family Service B'thorpe  
6.00pm Evensong Mowsley

### HOLY WEEK

See *Hexagon* for full details

20 PALM SUNDAY  
10.30am Benefice Service B'thorpe

27 EASTER SUNDAY  
10.30am Benefice Service Arnesby

*Short Communion every Wed. 9.15am HB*

Churchwarden:

Diana Jones 880741

Rector:

Liz Bickley 880351

### Methodist Church

6 United Circuit Service MH  
13 Rev Brian Kennard (Comm.)  
20 Mrs Jeanne Moore  
27 EASTER DAY  
Rev Frances Ballantyne (Comm.)  
*Services every Sunday 6.30pm.*  
*All Welcome*

Contacts:

Rev. Brian Kennard 462889

Senior Church Steward:

Mr. A Lloyd Jones 880343

### St Mary's Roman Catholic Church

*Services every Sunday 8.30am.*

Contact:

Robert Constable-Maxwell 880361

Father Owen O'Neil 462359

## DIANE E. HALL

'THE WHITE HOUSE BEAUTY ROOM'

\*

**\*\*Step into March with a relaxing back massage and\*\*  
facial - 10% OFF**

\*

Stockist of Susan Molyneux Skincare

\*waxing \*pedicures \*lashes \*exfoliating treatment \*  
Christmas Vouchers & Gifts available

**Tel: 01858 880567 or 07732 571714**



*The UK's only Tank Paintball Battle Venue*

\*Tank Drive Experiences \*Dads & Lads Experiences\*  
\*Military Vehicle Driving \*Military Vehicle Driving\*  
\*Children's Military Vehicle Party \*Woodland Paintball\*  
\*Archery\*

\*Air Rifle Shooting\*

Suitable for individuals, Family Fun, Corporate Events  
Stag/Hen Parties

**\*\*Gift Vouchers Available\*\***

**www.armoureddon.co.uk Tel: 01858 880239**

**Bookings by Appointment Only**





## DIARY DATES for MARCH

Tuesday 1 <sup>st</sup>	Parish Council meeting, 7.45pm Committee Room, Village Hall
Wednesday 2 <sup>nd</sup>	Historical Society talk - 'The Hollywood Production Code', 7.30pm Church Hall
Saturday 5 <sup>th</sup>	Village Spring Clean <b>PLEASE NOTE CHANGE OF DATE</b> , 2.00pm - 4.00pm VH
Wednesday 9 <sup>th</sup>	All Saints PCC AGM, 7.00pm Church
Friday 11 <sup>th</sup>	Causeway Coffee Morning, 10.00am -11.30am Church Hall
Friday 18 <sup>th</sup>	Mobile Library
Saturday 19 <sup>th</sup>	Millennium Wood workparty, 9.30am - 12.00noon
Sunday 27 <sup>th</sup>	BRITISH SUMMER TIME COMMENCES
Tuesday 29 <sup>th</sup>	Village Lunch, 12.30pm Kilworth Springs Golf Club

## FORTHCOMING EVENTS

Friday, April 1 <sup>st</sup>	Lutterworth Police Beat surgery
Wednesday, April 6 <sup>th</sup>	Historical Society AGM followed by Peter Liddle talk
Saturday, April 9 <sup>th</sup>	LOROS Coffee Morning and Bring & Buy Sale
Thursday, April 21 <sup>st</sup>	The Queen's 90 <sup>th</sup> Birthday village beacon lighting
Sunday, May 15 <sup>th</sup>	FOBS Treasure Hunt
Saturday, June 18 <sup>th</sup>	FOBS Safari Supper
Saturday, November 26 <sup>th</sup>	FOBS Christmas Event

### LOCAL PLANNING NEWS

The following applications have been submitted to Harborough District Council:

■ 16/00098/FUL [Mr Jacob Sykes] Erect 7 silos, install farm track & siting of 1 temporary mobile home and 3 permanent mobile homes (part-retrospective), Stud Farm, Station Road

■ 16/00205/NMA [Mr Ben Skinner] Install roof lights & alteration to fenestration (*amendment to 11/01521/FUL*), 31-33 High Street

**Recently determined applications:**

■ 15/00944/FUL [Springfield Supermarkets Ltd] Extensions to existing dwelling & conversion to form 3 dwellings, assoc. landscaping & parking, 5 High Street

**Planning Enforcement Cases (pending)**

■ 16/00016/COMS 12 Church Lane, materials non-compliant with planning permission (*Ref. 14/00089/FUL*)

*Current applications may be inspected during normal working hours at the Council Offices, The Symington Building, Adam & Eve Street, Market Harborough. Comments concerning planning applications should be addressed to the Development Control Manager:*

*Planning applications and other aspects of local government can now be viewed on-line at [www.harboroughonline.co.uk](http://www.harboroughonline.co.uk)*

### MOBILE LIBRARY

#### NOTE CHANGES TO SERVICE

*The Mobile Library will now be calling on the third Friday of each month.*

#### STOPS & TIMES

School, Welford Road: **10.35am - 11.35am**

Berridges Lane: **11.40am - 12.20pm**

Church Street: **12.25pm - 1.00pm**

**Now lending Talking Books on CD & tape**

\*\*\*\*\* You can now renew on-line or by phone \*\*\*\*\*

### BUGLE.....FREE ADS.

Phone Sylvia on 880902 or email: [sylvia1\\_p@hotmail.co.uk](mailto:sylvia1_p@hotmail.co.uk)

#### OFFERS in aid of Church Funds:

Dark oak cupboard/2 drawer unit. 48"H, 33"W, 18"D

Whitewood 6 drawer chest 39"H, 23"W, 18"D

Shelf unit, 10 pigeon hole 51"H, 24"W, 18"D

Children's toy storage unit, 15 shallow bins 21"H, 42"W, 17"D.

All items ex-Church Hall playgroup.

Contact: Di Jones 880741 or Lorrie Forman 880281

## Paul Bolton School of Motoring

Professional Driving Standards Agency Instructor  
New Citroen DS3 with dual controls  
Flexible pick up & drop off to your requirements  
Free sign up for online Theory Test study



Call Text or Email  
01858 880115  
07736 457 986  
[paul\\_bolton@hotmail.com](mailto:paul_bolton@hotmail.com)



**DAY CARE** for 3 months to 5 years of age  
Warm, homely and secure atmosphere.

The nursery is part of The Honey-pot Dairy Farm; this countryside setting provides children with limitless outdoor opportunities, creating a huge range of developmental and learning experiences.

For a Prospectus or more information please call 01858 881038

Visit us at 10 Church Street, HB  
or email: [dairyfarmdaynursery@yahoo.com](mailto:dairyfarmdaynursery@yahoo.com)

**LIFE'S ADVENTURE STARTS HERE**